

Legend			
	IR, US & State Routes		48-Hour Class Counts
	County Roads		48-Hour Volume Counts
	Township Roads		24-Hour Class Counts
	Muni Streets		24-Hour Volume Counts
	Ramps		Traffic Counts (See Other Maps for Details)
	NHS Sections		HPMS Sections
	County Boundary		Streams
	Interchange Maps		Cities
	Bodies of Water		

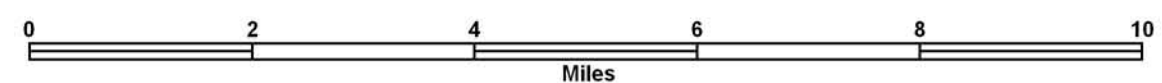

Ottawa
County Traffic Count Map
4/17/2009
Scale: 1 : 109,354

Ohio Department of Transportation
 Office of Technical Services
 Traffic Monitoring Section
 ODOT.Traffic.Counts@dot.state.oh.us
 614-466-3727

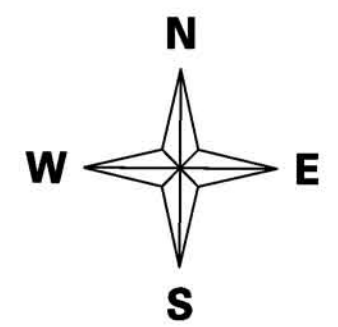

**Traffic Counts
in
Elmore
Ottawa
County**

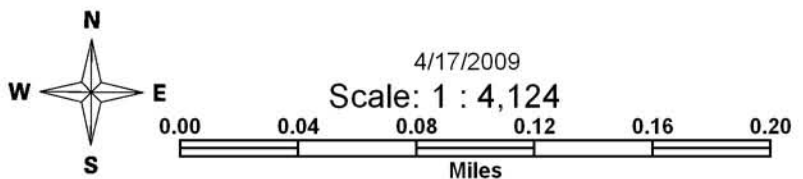
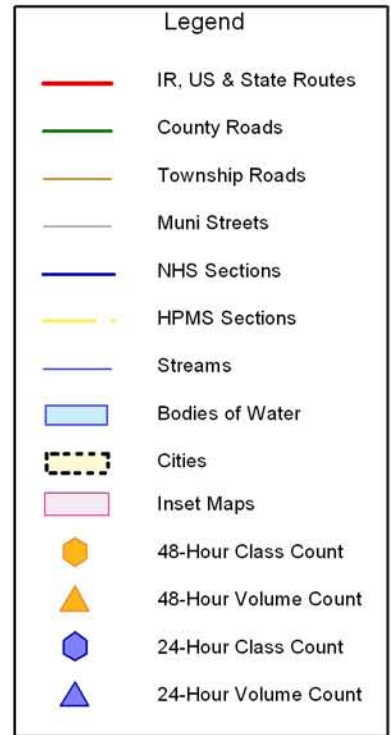

**Ohio Department of Transportation
Office of Technical Services
Traffic Monitoring Section**
ODOT.Traffic.Counts@dot.state.oh.us
614-466-3727



Traffic Counts in Genoa

Ottawa County

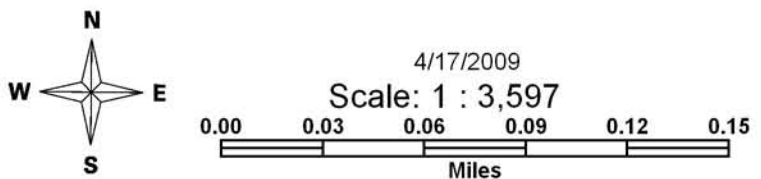
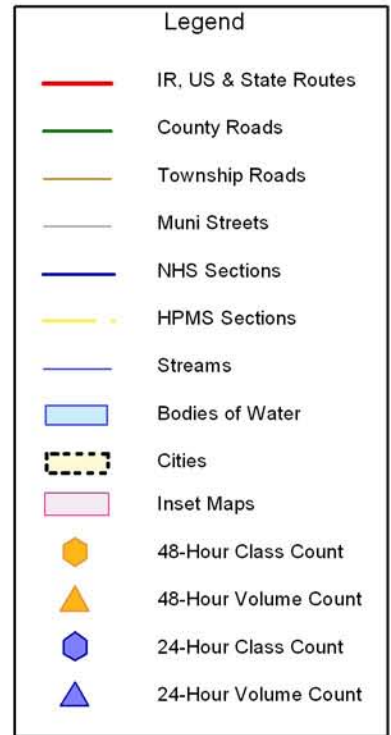
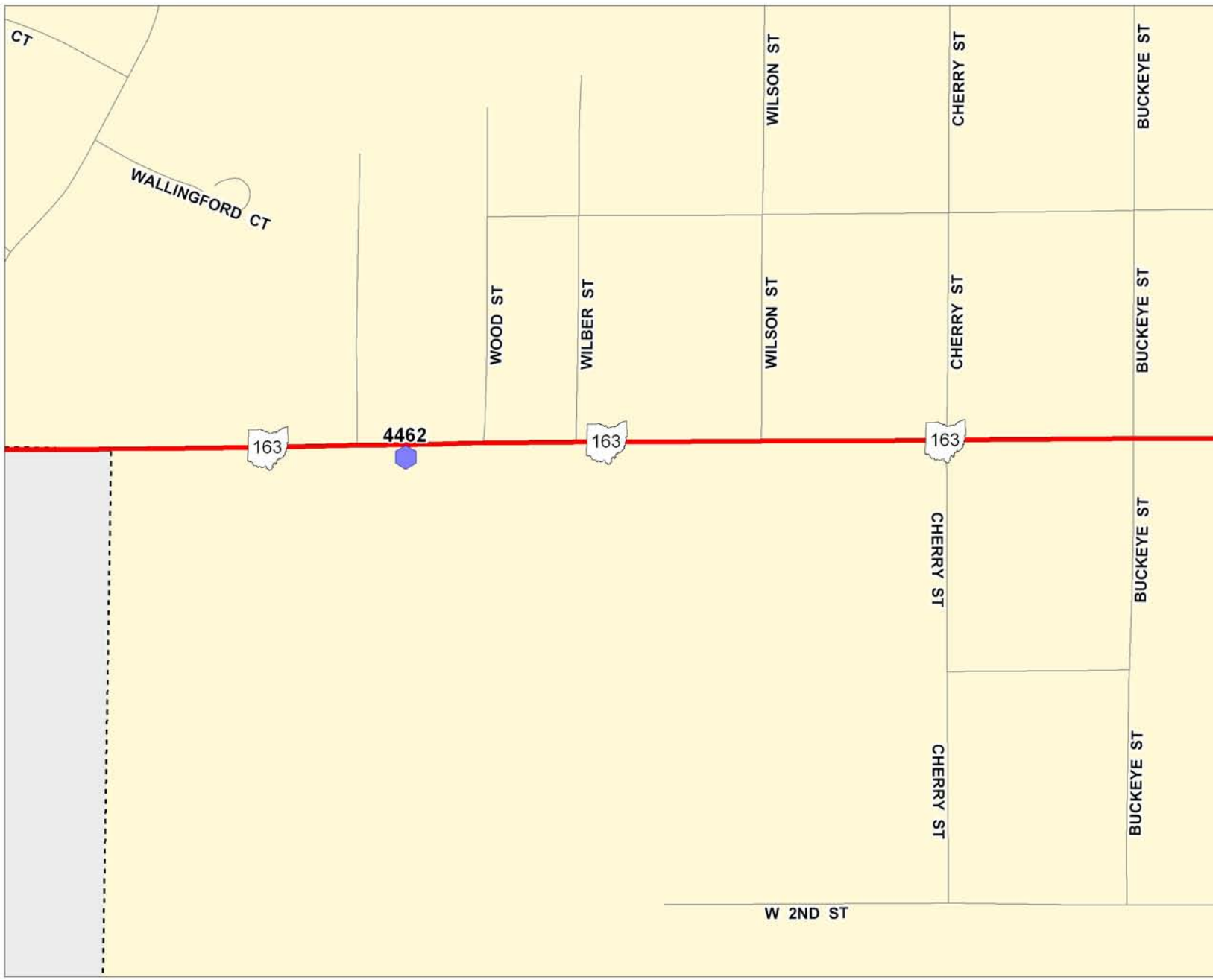

Ohio Department of Transportation
 Office of Technical Services
 Traffic Monitoring Section
 ODOT.Traffic.Counts@dot.state.oh.us
 614-466-3727



Traffic Counts in Marblehead

Ottawa County

Legend

-  IR, US & State Routes
-  County Roads
-  Township Roads
-  Muni Streets
-  NHS Sections
-  HPMS Sections
-  Streams
-  Bodies of Water
-  Cities
-  Inset Maps
-  48-Hour Class Count
-  48-Hour Volume Count
-  24-Hour Class Count
-  24-Hour Volume Count

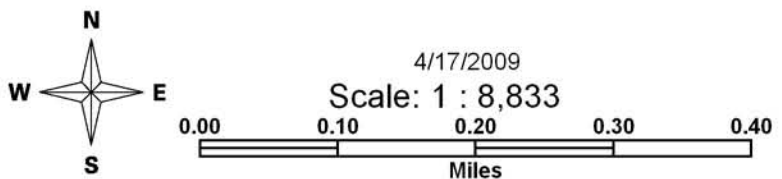

Ohio Department of Transportation
 Office of Technical Services
 Traffic Monitoring Section
 ODOT.Traffic.Counts@dot.state.oh.us
 614-466-3727



4/17/2009
 Scale: 1 : 8,833

Traffic Counts in Oak Harbor

Ottawa County

Legend

-  IR, US & State Routes
-  County Roads
-  Township Roads
-  Muni Streets
-  NHS Sections
-  HPMS Sections
-  Streams
-  Bodies of Water
-  Cities
-  Inset Maps
-  48-Hour Class Count
-  48-Hour Volume Count
-  24-Hour Class Count
-  24-Hour Volume Count

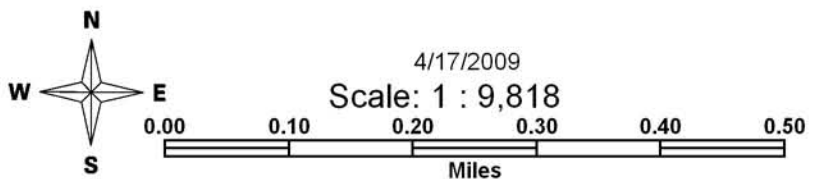

Ohio Department of Transportation
Office of Technical Services
Traffic Monitoring Section
ODOT.Traffic.Counts@dot.state.oh.us
614-466-3727



Traffic Counts in Port Clinton

Ottawa County

Legend

-  IR, US & State Routes
-  County Roads
-  Township Roads
-  Muni Streets
-  NHS Sections
-  HPMS Sections
-  Streams
-  Bodies of Water
-  Cities
-  Inset Maps
-  48-Hour Class Count
-  48-Hour Volume Count
-  24-Hour Class Count
-  24-Hour Volume Count

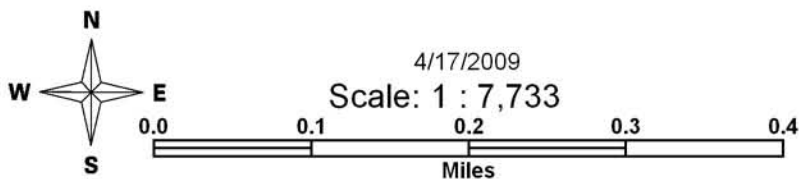

Ohio Department of Transportation
Office of Technical Services
Traffic Monitoring Section
ODOT.Traffic.Counts@dot.state.oh.us
614-466-3727



Ottawa County

Inset Map # 1

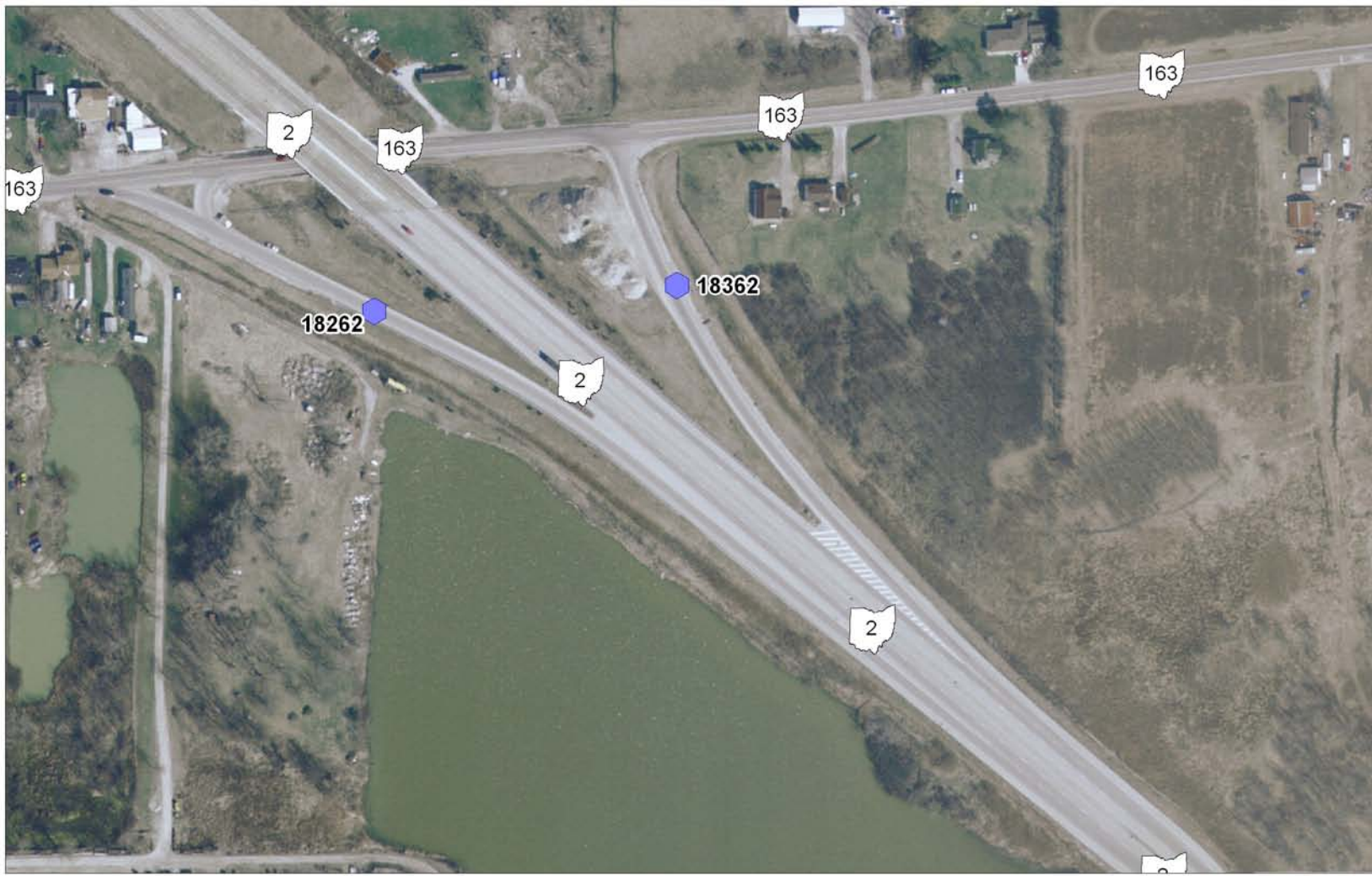

Routes
SR 2
&
SR 163

Legend

- Yellow hexagon: 48-Hour Class Count
- Yellow triangle: 48-Hour Volume Count
- Blue hexagon: 24-Hour Class Count
- Blue triangle: 24-Hour Volume Count

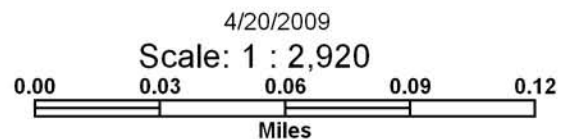





Ohio Department of Transportation
Office of Technical Services
Traffic Monitoring Section
ODOT.Traffic.Counts@dot.state.oh.us
614-466-3727



Ottawa
County

Inset Map
2

Routes
SR 2
&
SR 53

Legend	
	48-Hour Class Count
	48-Hour Volume Count
	24-Hour Class Count
	24-Hour Volume Count

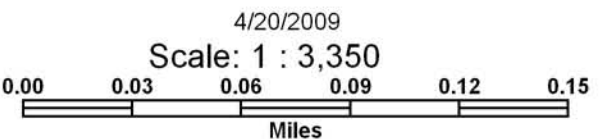

Ohio Department of Transportation
Office of Technical Services
Traffic Monitoring Section
ODOT.Traffic.Counts@dot.state.oh.us
614-466-3727







**Ottawa
County**

**Inset Map
3**

Routes
SR 2
&
SR 163

Legend

-  48-Hour Class Count
-  48-Hour Volume Count
-  24-Hour Class Count
-  24-Hour Volume Count

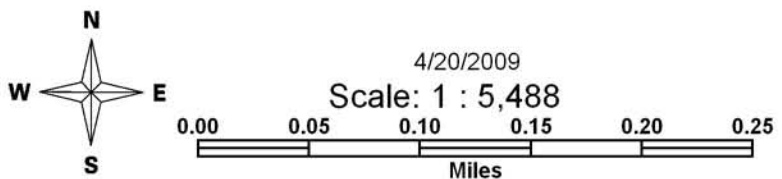
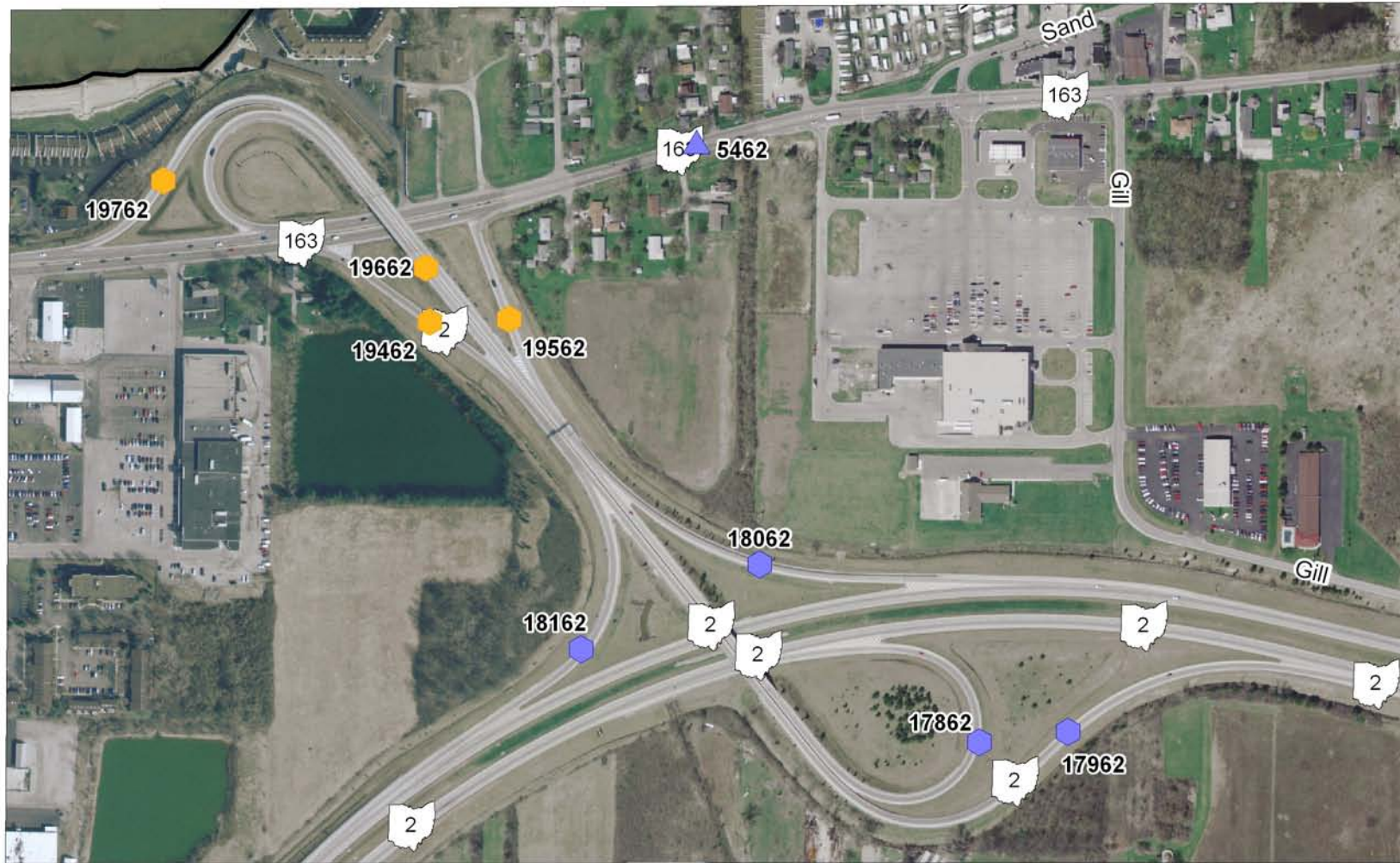

**Ohio Department of Transportation
Office of Technical Services
Traffic Monitoring Section**
ODOT.Traffic.Counts@dot.state.oh.us
614-466-3727



Ottawa County

Inset Map # 4



Routes
SR 2
&
SR 53

Legend

- Yellow circle: 48-Hour Class Count
- Yellow triangle: 48-Hour Volume Count
- Blue hexagon: 24-Hour Class Count
- Blue triangle: 24-Hour Volume Count

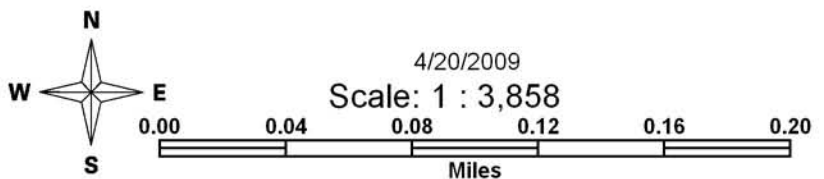

Ohio Department of Transportation
Office of Technical Services
Traffic Monitoring Section
ODOT.Traffic.Counts@dot.state.oh.us
614-466-3727



Ottawa
County

Inset Map
5

Routes
SR 2
&
SR 269

Legend

- 48-Hour Class Count
- 48-Hour Volume Count
- 24-Hour Class Count
- 24-Hour Volume Count

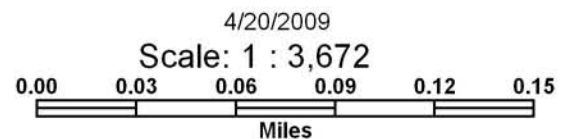
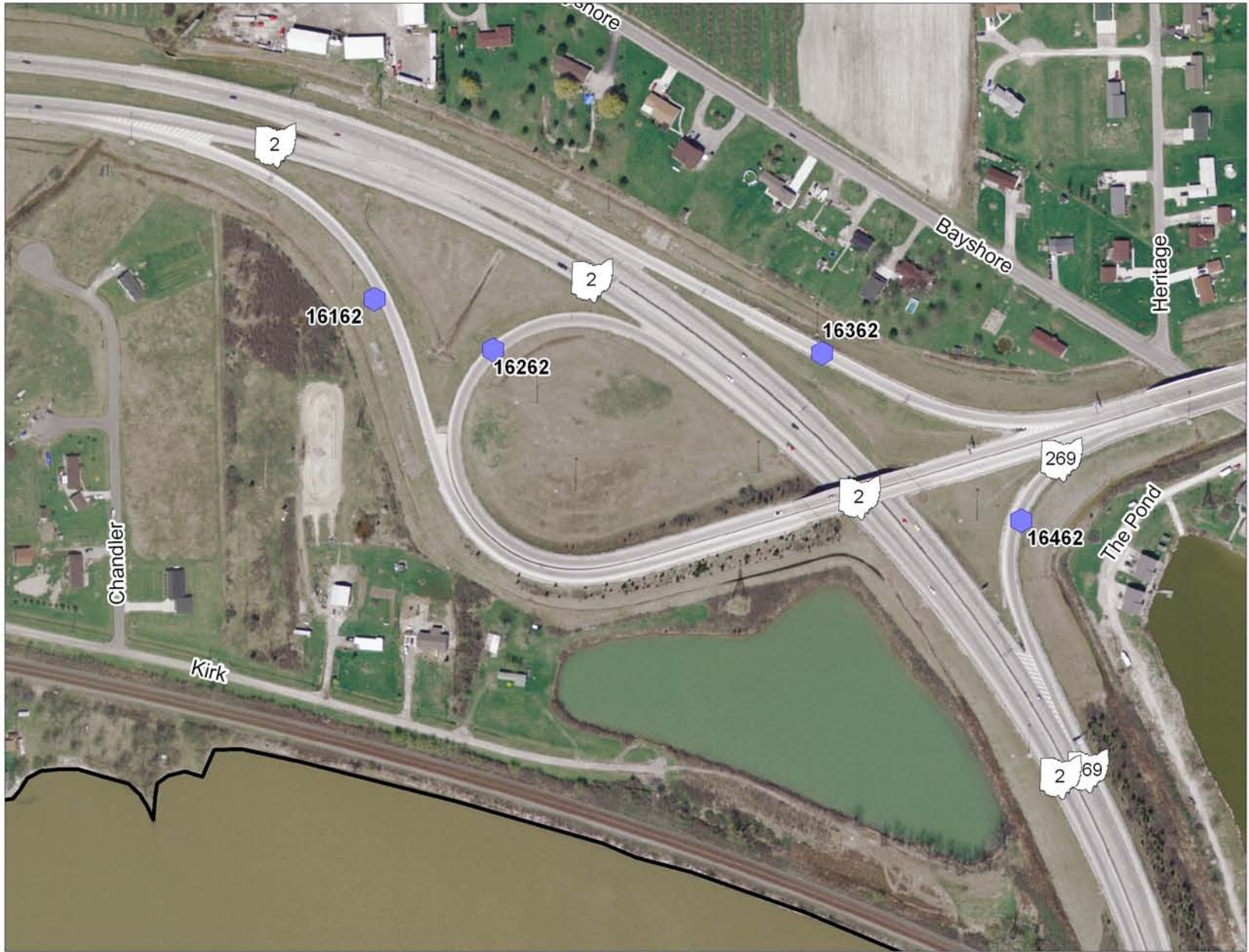





Ohio Department of Transportation
Office of Technical Services
Traffic Monitoring Section
ODOT.Traffic.Counts@dot.state.oh.us
614-466-3727



Ottawa County

Inset Map # 6

Routes
SR-163
&
SR-269

Legend	
	48-Hour Class Count
	48-Hour Volume Count
	24-Hour Class Count
	24-Hour Volume Count

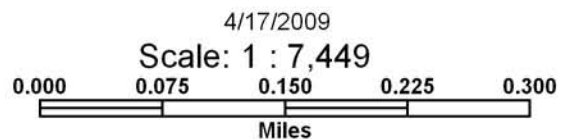

Ohio Department of Transportation
Office of Technical Services
Traffic Monitoring Section
ODOT.Traffic.Counts@dot.state.oh.us
614-466-3727

